

This drawing may contain: Ordnance Survey material by permission of Ordnance Survey on behalf of the Controller of Her Majesty's Stationery Office © Crown Copyright 2019. All rights reserved. Reference number 0100031673.

PROJECT TITLE
Southend United - Fossetts Farm

OS Open data / © Natural England / © DEFRA / © DECC / © English Heritage.
Aerial Photography - ESRI, DigitalGlobe, GEOEye, i-cubed, USDA FSA, USGS, AEX, Getmapping, Aerogrid, IGN, IGP, swisstopo, the GIS User Community

| REV. | DESCRIPTION | APP. DATE |
|-----------|---|------------------|
| 03 | Issued for Planning - Consultation Amendments | MW 16.03.21 |
| ISSUED BY | London | T: 020 7467 1470 |
| DATE | 17 Sept 2020 | DRAWN AK |
| SCALE@A3 | 1:2,000 | CHECKED NB |
| STATUS | Planning | APPROVED MW |

DRAWING TITLE
Landscape Parameter Plan

No dimensions are to be scaled from this drawing.
All dimensions are to be checked on site.
Area measurements for indicative purposes only.

© LDA Design Consulting Ltd. Quality Assured to BS EN ISO 9001 : 2015

DWG. NO
FOF-LDA-XX-XX-XX-DR-N-ST-00005

Sources Ordnance Survey

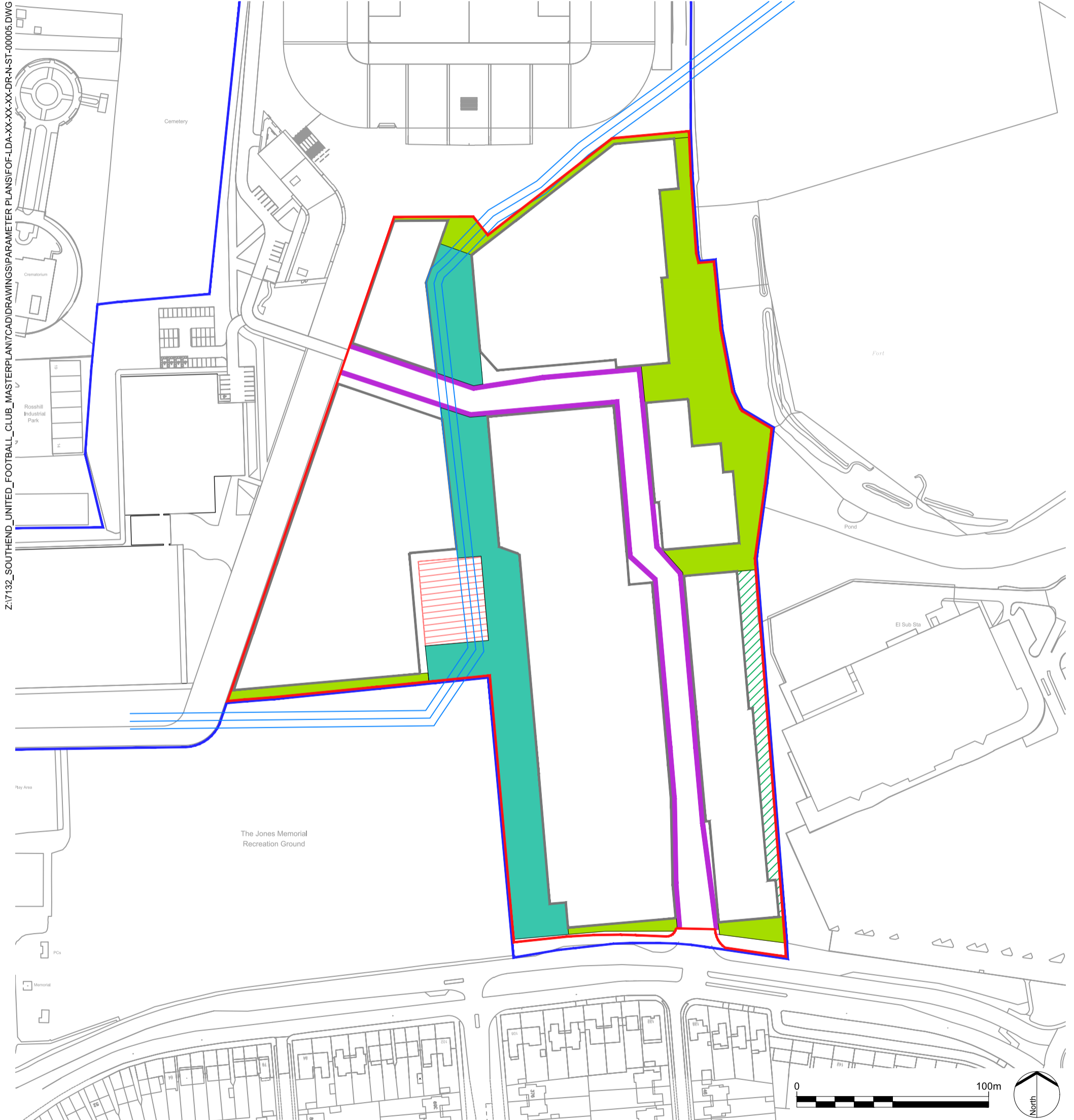

- LEGEND**
- Outline Area of Hybrid Planning Application
 - Hybrid Planning Application Boundary
 - Development Envelope
 - Public Open Space - Linear Park. The location of the public open space may vary in accordance with tolerances of variation defined within the Vehicle Access Parameter Plan
 - Public Realm including town squares, pocket parks, and structural landscape
 - Existing landscape buffer to be retained
 - High Pressure Sewer Easement
 - Jones Memorial Ground Parking. Location may vary in accordance with the tolerance of variation defined within the Vehicle Access Parameter Plan

Primary Street with shared pedestrian and cycle access within the street. Pathway location may vary in accordance with the tolerance of variation defined within the Vehicle Access Parameter Plan.

- Notes**
1. The public open space within the linear park is to be a minimum of 0.75 hectares.
 2. The public realm including town squares, pocket parks and structural landscape is to be a minimum of 0.73 hectares.
 3. The public open space, public realm and streetscapes outside of the denoted development envelopes allow for the provision of structures for cycle parking and transport infrastructure.

